

Honeycomb Earrings

By TrendSetter Virginia Jensen

Copyright 2015 © Starman, Inc. & Artist. Not licensed for digital distribution.
Promotional use only—no resale of instructions permitted. Version 1.0

THE BUILDING BLOCKS OF MODERN BEADING

Structural designs build quickly and easily with the CzechMates® Dimensional Beading System.

ABOUT THE ARTIST: VIRGINIA JENSEN



After a career in graphic design, I discovered beading. I taught myself from books and magazines and quickly took up the techniques. Soon after, I began to design and teach. I have had numerous projects published, and I am most excited about my books: *Cube Bead Stitching*, *Contemporary Cube Bead Designs* and *Stitching with Two-Hole Beads*. I enjoy the challenge of creating a functional, wearable piece of art. Visit www.virjenmettle.com



COLORWAYS: Gold/Copper – CzechMates QuadraTile Matte Metallic Antique Copper (387-06-K0175); CzechMates Bar Dk Bronze (389-26-14415); Melon 5mm 24k Gold (287-05-270); TOHO Round 8° Higher-Metallic Amethyst (TR-08-502); TOHO Round 11° Bronze (TR-11-221). **Gold/Red (Not shown)** – CzechMates QuadraTile Opq Luster Picasso (387-06-P65401); CzechMates Bar Jet (389-26-2398); Melon 5mm Sunset Maple (287-05-B9004); TOHO Round 8° Gold-Lustered Trans. Pink (TR-08-421), PF Galv. Starlight (TR-08-PF557); TOHO Round 11° Lt. Amethyst/Pink Lined (TR-11-959), Bronze (TR-11-221).

STARMAN
TRENDSETTERS

MATERIALS for 2 earrings

- 24 CzechMates® QuadraTiles (QT)
- 12 CzechMates® Bars (BR)
- 12 Melon Rounds 5mm (MR)
- 48 8° TOHO Seed Beads (SB8)
- 108 11° TOHO Seed Beads (SB11)
- 2 Closed Jump rings
- 2 Earring findings
- Fireline or Wildfire

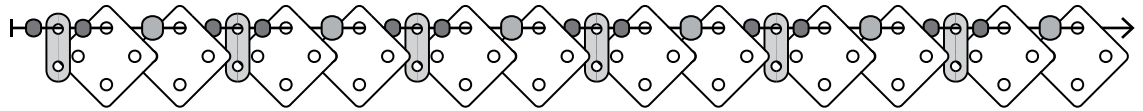

Step 1a

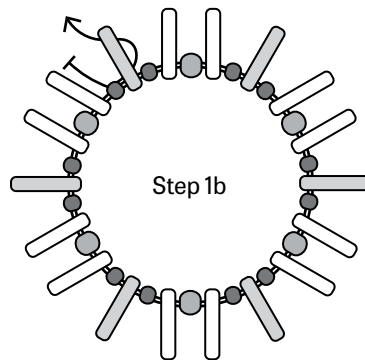

Step 1b

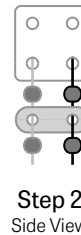

Step 2
Side View

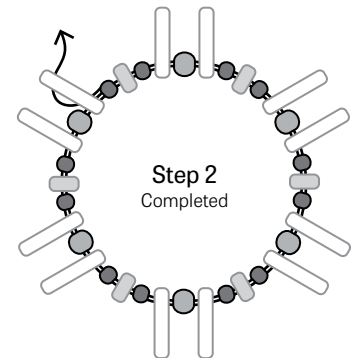

Step 2
Completed

INSTRUCTIONS

1. a) On one yard of thread, add SB11, BR, SB11, QT, SB8, QT. Repeat adding this sequence five times for a total of 12 QuadraTiles (QT) strung on.
b) Form a ring and tie a knot. Pass through all beads again until you reach the first BR. Jump through the second hole of the BR.
2. Add SB11 then pass through an open hole of the adjacent QT so that the two remaining open holes of the QT are facing outward. Add SB8, pass through an open hole of the adjacent QT so that the two remaining open holes face outward. Add SB11, pass through the second hole of the adjacent BR. Repeat five times to fill in the remainder of the ring. Pass through all beads again. Continue passing through a QT, then jump to an open outer hole.
3. a) Add SB11, MR, SB11, then pass through the corresponding open hole of the adjacent QT. Add SB8, then pass through the corresponding open hole of the adjacent QT. Repeat five times, until 6 MR are added. Pass through all beads again. Continue passing until exiting an MR.
b) Add SB11 and pass through the remaining open hole of QT. Add SB8, pass through the remaining open hole of QT. Add SB11, pass through MR. Repeat five times to fill in the remainder of the ring. Pass through all beads again. Continue passing until exiting a SB8.
4. Add two SB11 and a jump ring, then pass back through the second SB11. Add SB11 then pass through SB8 again. Pass through the loop again for strength. Continue passing until exiting the SB8. Pass through the adjacent QT, then jump to the second upper hole. Repeat adding three SB11s to the jump ring. Weave into the piece before tying off. Attach the earring to the jump ring. Repeat all steps for the second earring.

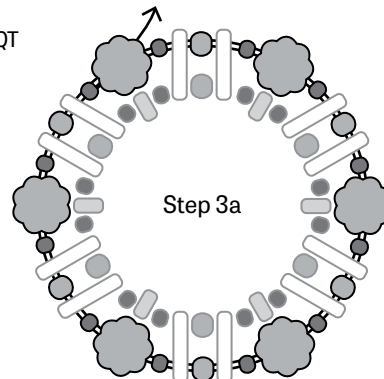

Step 3a



Step 3b
Side View

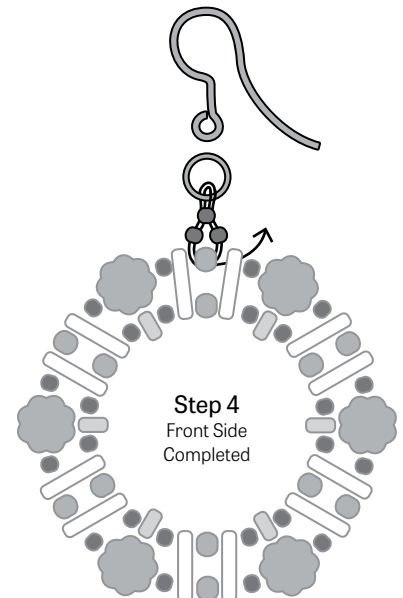

Step 4
Front Side
Completed

ARTIST'S TIP

The earring should hang from your ear parallel to the neck. Depending on your finding, this step may need to be modified to achieve the desired affect.